

Flat 2, Holly House 55 Edge Lane, Stretford, Trafford, M32 8PA



JP&Brimelow
ESTATE AGENTS

Offers In The Region Of £210,000



VIDEO TOUR AVAILABLE A deceptively spacious TWO DOUBLE BEDROOM ground floor apartment positioned in this well-kept apartment block on Edge Lane in Stretford. The property is situated on a popular residential, tree lined road and within walking distance to Longford Park, Stretford Mall and Chorlton. Only a 5-minute walk from the Metrolink station. The well-planned accommodation consists of a communal entrance leading to its own private entrance hallway, two double bedrooms, a three-piece bathroom suite, a fully fitted kitchen/diner and a separate cozy lounge. The property benefits from an allocated parking space entered via Kings Road and its own garage, communal store rooms.





EPC Chart

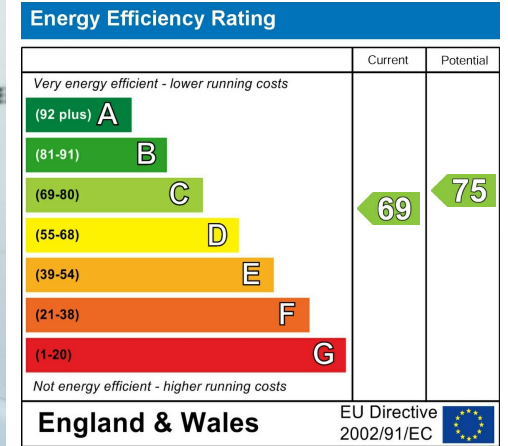

Tenure: **Leasehold** Council Tax Band: **B**

Ground Floor

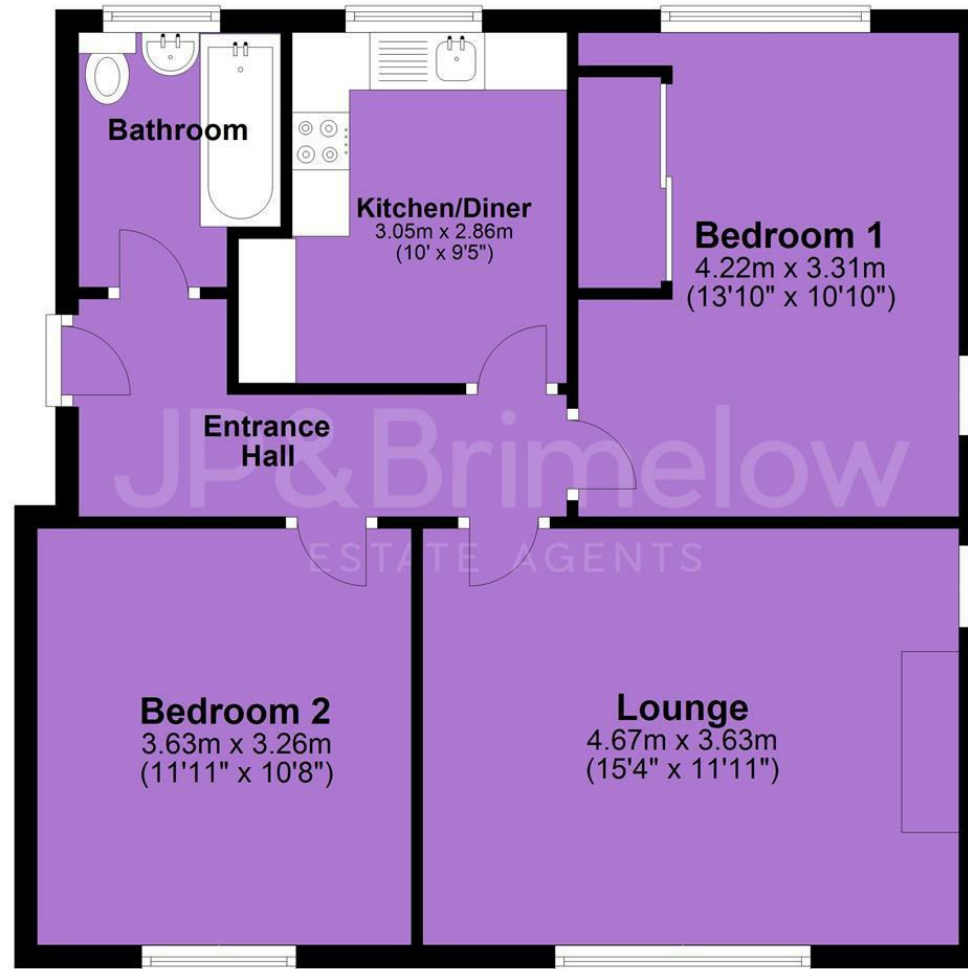

JP & Brimelow Estate Agents Ltd
430 Barlow Moor Road, Manchester, M21 8AD
Tel: 0161 8822233
E: sales@jpbrimelow.co.uk www.jpandbrimelow.co.uk



JP & Brimelow
ESTATE AGENTS

NOTICE: JP & Brimelow Estate Agents Ltd for themselves and for the vendors or lessors of this property whose agents they are give notice that:

- (i) the particulars are set out as a general outline only for the guidance of intending purchasers or lessees, and do not constitute, nor constitute part of, an offer or contract;
- (ii) all descriptions, dimensions, references to the condition and necessary permissions for use and occupation, and other details are given in good faith and are believed to be correct but any intending purchasers or tenants should not rely on them as statements or representations of fact but must satisfy themselves by inspection or otherwise as to the correctness of each of them;
- (iii) no person in the employment of JP & Brimelow Estate Agents Ltd has any authority to make or give any representation or warranty whatever in relation to this property.

 [jpandbrimelowstateagents](https://www.instagram.com/jpandbrimelowstateagents)

 [@jpandbrimelow](https://www.twitter.com/jpandbrimelow)